

# Design Sheet - Windposts to BS EN 1993 (Eurocode 3)

Please complete questions 1 to 12 below; this will enable us to produce working drawings for your approval prior to manufacture. Please note, we will not commence with the production of any posts based on the information on design sheets. Production will only start following the approval of our working drawings.

**Note:** Where loads are provided, a partial safety factor ( $\gamma_M$ ) of 1.5 will be used to check serviceability.

## 1. Contact Details

Contact Name .....

Company .....

Office Address .....

.....

.....

Project Name .....

Site Address .....

Tel .....

Email .....

Order No. ....

## 2. Purpose of Your Enquiry (tick box as appropriate)

New Quote       New Order       Amendment to Existing Quote       Existing Order

## 3. Type of Windpost:

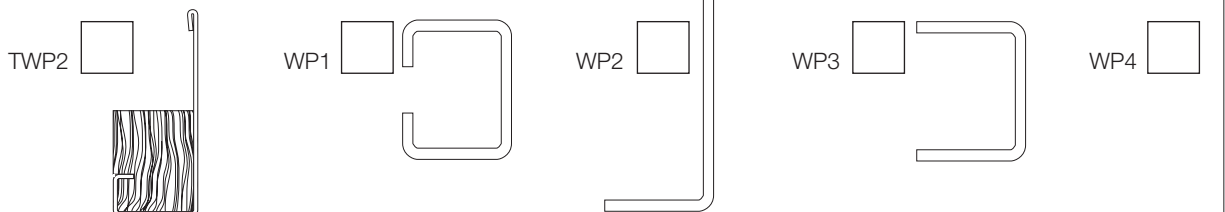

**Note:** Windposts will be detailed and supplied as orientated above unless otherwise stated.

### 3a. If WP2 or TWP2, indicate wall tie conditions crossing post:

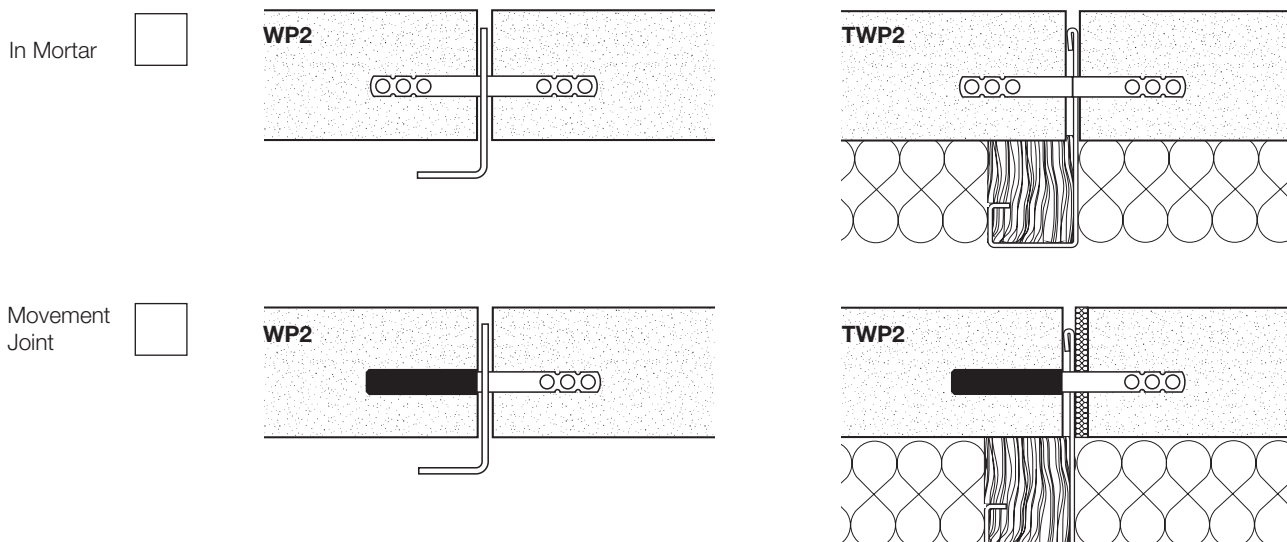

## 4. Number Required

Number of windposts required to this specification .....

Email to [info.ancon.uk@leviat.com](mailto:info.ancon.uk@leviat.com)

Leviat, President Way, President Park, Sheffield, S4 7UR, UK.  
Tel: +44 (0) 114 275 5224 Web: [Ancon.co.uk](http://Ancon.co.uk) | [Leviat.com](http://Leviat.com)



**5. Wall Construction**

Please state brick, block, cavity and insulation widths (mm):

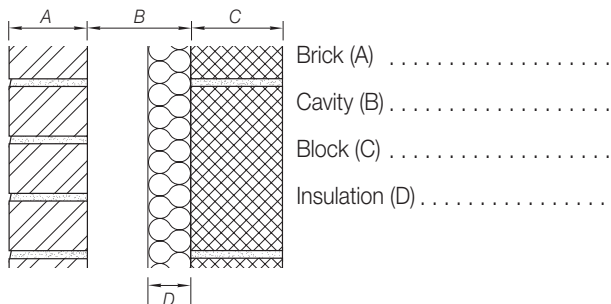

**6. Length**

Structural Opening a to b (mm)

.....

**Note:** Structural Opening heights for **TWP2 only** are limited to 4000mm

**7. State either**

Section Size e.g. TWP2 190-B .....

**OR**

Design Load/Post (kN) ULS e.g. 7kN.....

**8. Top Connection (tick one box only)**

Please indicate required top connection from drawings below and complete all applicable dimensions (see?).

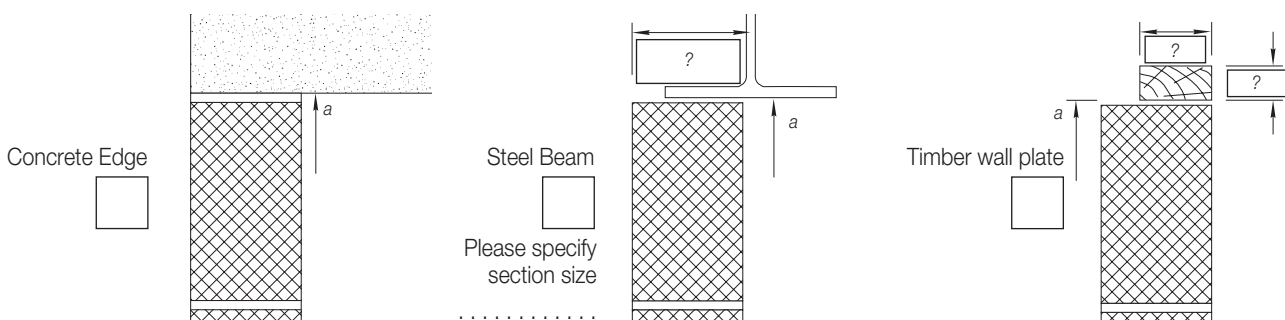

**9. Base Connection (tick one box only)**

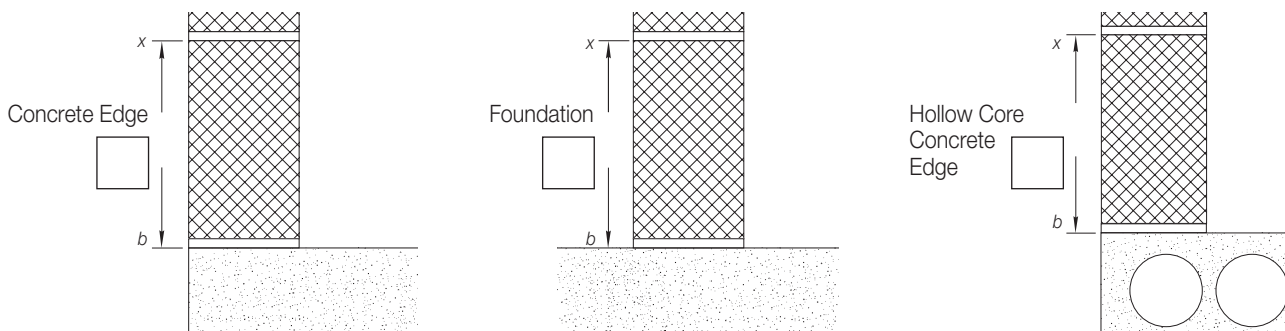

**10. Slot Dimension**

Please state dimension from base to first tie position to match coursing - b to x (mm) .....

**11. Drawings Attached**

No  Yes  (Please attach drawings showing section through building if available)

**12. Special Conditions**

No  Yes  .....  
 (Specify here or in an attachment)

(Post will be designed with standard Ancon Windpost Ties i.e. SPN/SDN/SNS, unless special conditions are specified e.g. thin joint mortar, remedial application etc.)

Email to [info.ancon.uk@leviat.com](mailto:info.ancon.uk@leviat.com)

Leviat, President Way, President Park, Sheffield, S4 7UR, UK.  
 Tel: +44 (0) 114 275 5224 Web: [Ancon.co.uk](http://Ancon.co.uk) | [Leviat.com](http://Leviat.com)

